

## Digital Environmental Control Panels

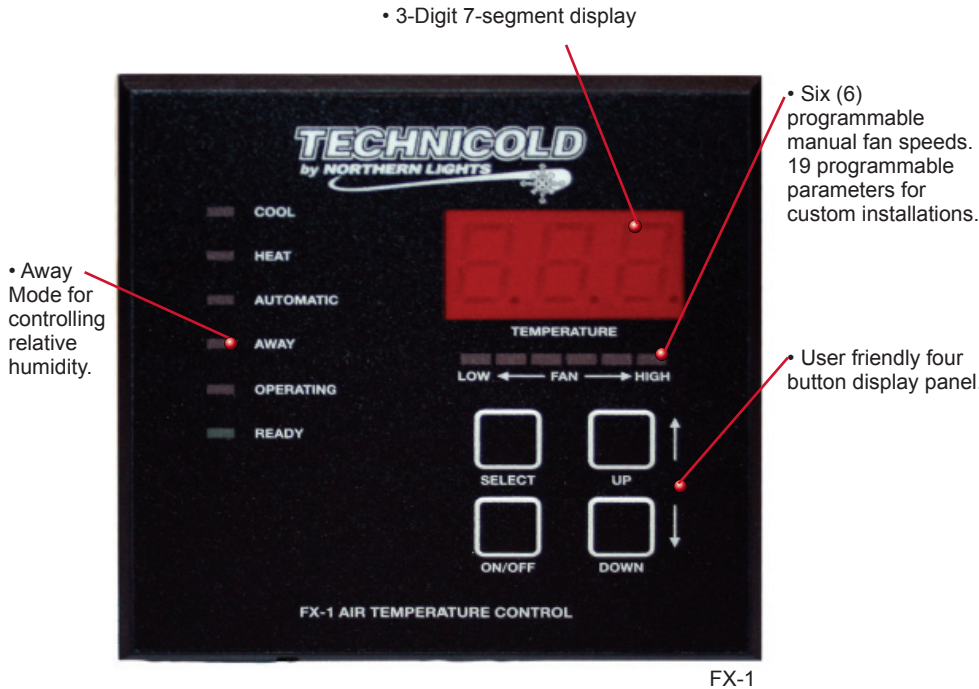

**Technicold offers a variety of FX panels to choose from.**



Technicold - the industry leader in marine climate controls - presents the optimal temperature control and monitoring systems: The FX Series of Digital Environmental Control Panels.

Utilizing a user-friendly, highly intuitive menu, the FX series has up to 17 different function programs that allow you to tailor your air conditioning system to your vessel's specific needs. Normal operation is a breeze - literally and figuratively - with a single button to set the desired temperature.

Technicold's FX control panels maintain cooling or heating while automatically monitoring and self-diagnosing the climate control system. The dehumidifying mode helps with environmental maintenance, ensuring a dry, odorless boat even while unattended.

A state-of-the art display panel with LED lights and soft-button interface provides a clear visual image of the current temperature, programs, fault messages and other optional screens. Available with brass, silver, black or gold enclosures, the FX-2 Series can complement any boat's interior.

Technicold's FX control panels are designed for ease of installation. No complicated wiring is required - the display panel and power control module connect with a polarized plug connection similar to a telephone or internet cable. The temperature sensor is connected to the main powerboard in the same matter.

If support is ever needed, Technicold's wealth of factory experience and worldwide service network is only a phone call or mouse click away. The best built, best designed, and best backed marine systems in the industry are available from Technicold by Northern Lights.

### Standard Features:

- 7' brass air temperature sensor
- 7' brass water temperature sensor
- 15' display cable
- 1 control module with enclosure

### Options:

- Additional sensor and display cable lengths are available. Consult Factory.
- High amperage controls are available. Consult Factory.



[www.technicold.com](http://www.technicold.com)



[www.northern-lights.com](http://www.northern-lights.com)

## Digital Control Dimensions

NOTE: THE FX-MAXX 'HIDEAWAY CONTROL' IS THE SAME AS THE STANDARD FX-MAXX CONTROL WITH ADDITION OF A BEZEL AND DOOR. THE ADDITION OF THE BEZEL PREVENT THE USE OF A FACE PLATE SENSOR. THEREFORE AN ALTERNATE AIR SENSOR MUST BE INSTALLED WHEN USING THIS DISPLAY.

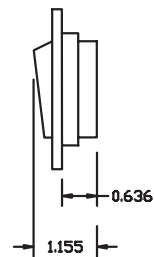
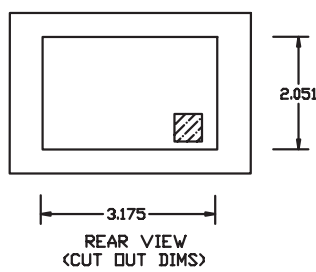
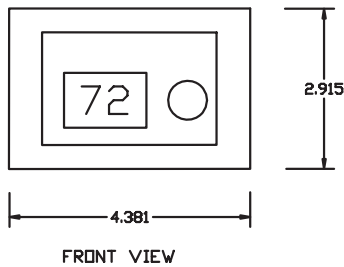
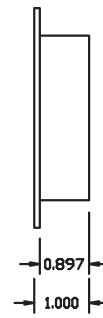
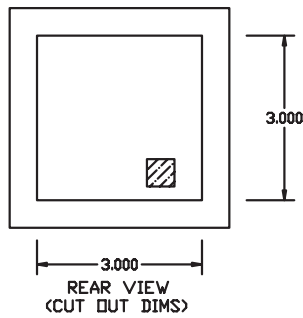
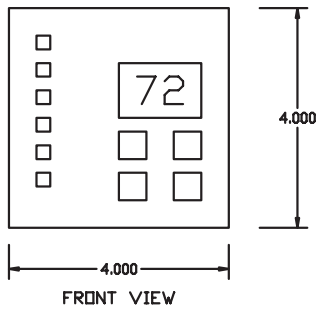
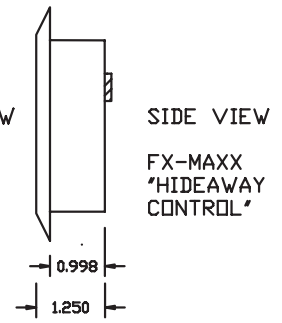
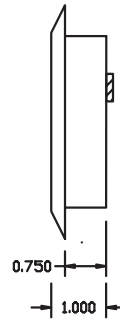
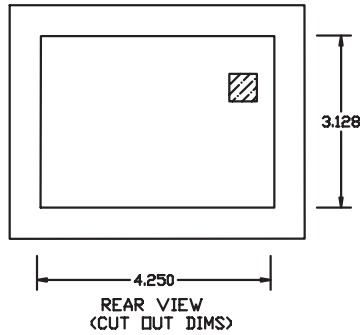
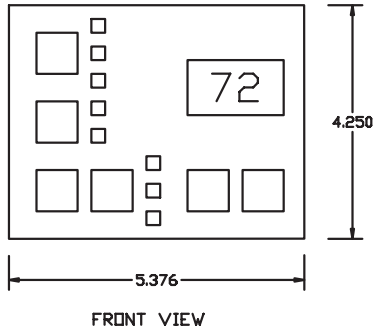

DWG# OE70000A